A low-angle photograph of the interior of St Pancras Church, focusing on the dome. The dome is supported by several tall, dark green marble columns with gold-colored capitals. The ceiling is a vibrant blue with intricate gold-colored scrollwork and floral patterns. Three large, colorful stained glass windows are visible, each depicting a religious scene. In the center, a gold cross is mounted on a pedestal. The foreground shows a white marble wall with a decorative border.

Venue Hire
St Pancras Church
Euston Road, London

[Click Here to Download
Church Hire Application Form
Standard Charges and Terms](#)

St Pancras Church, Venue Hire

- Location and Transport Links 1
- Introduction 2-3
- Capacity 4
- Musical Instruments 5
- Building Plans 6-9
- Charges 10-12
- Applications for Hiring 13
- Frequently Asked Questions 14
- Our other Spaces 15
- Contact Details 16

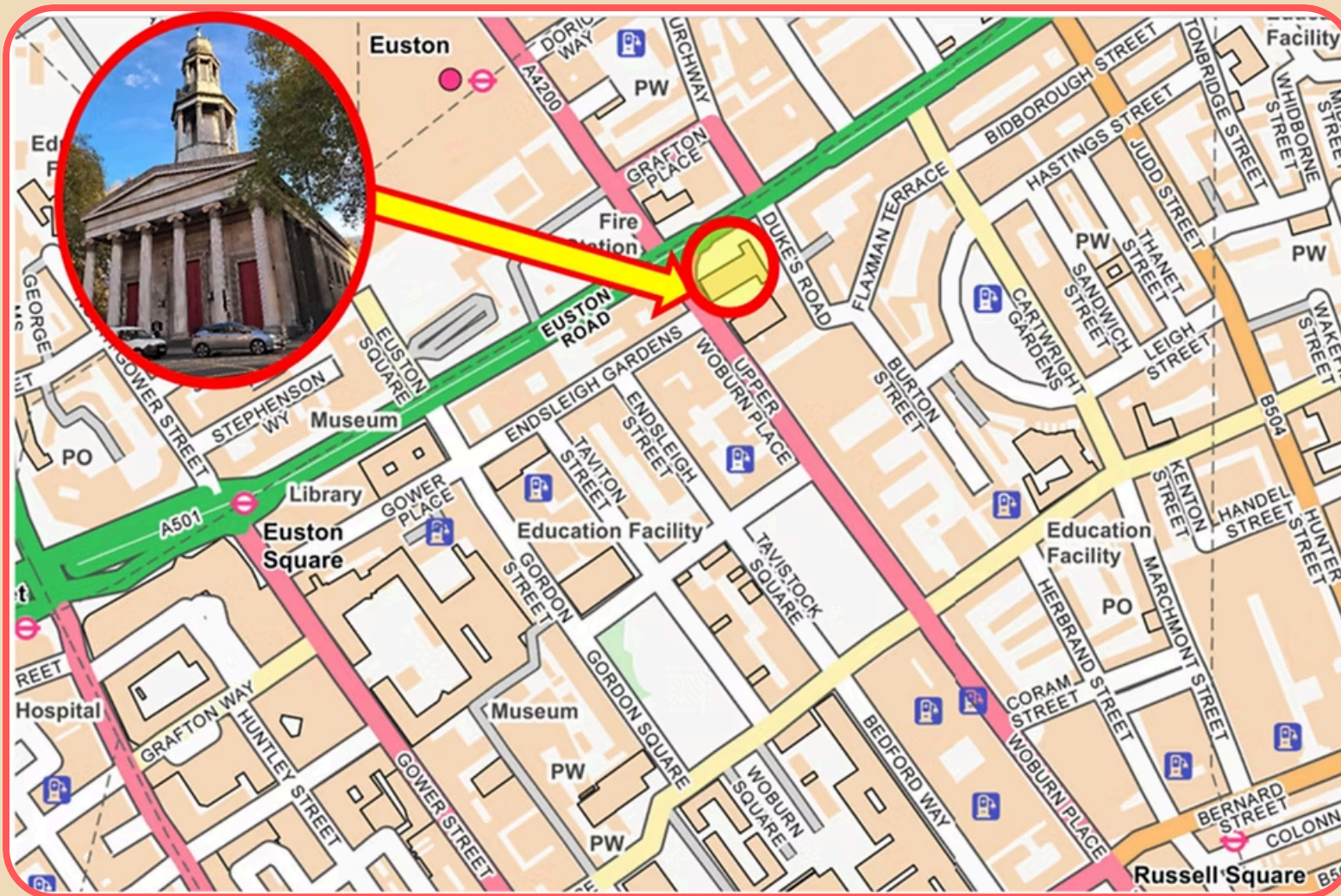

Prominent Location

Main Entrance

The main entrance for St Pancras Church, Euston Road, is through the huge red doors off Upper Woburn Place..

On foot - NW1 2BA

St Pancras Church is in easy walking distance for Kings Cross / St Pancras, Bloomsbury and Camden.

Excellent Public Transport Links

Trains and Tubes are only a few minutes walk away - at Euston, St Pancras International, King's Cross, Euston Square and Russell Square.

Buses (routes 1, 68, 91, and night bus N91), stop outside church on Upper Woburn Place and nearby stops serve others areas through routes 30, 73, 205, 390 and various night buses.



St Pancras Church



St Pancras Church (also known as St Pancras New Church) welcomes enquiries for the hire of our beautiful and acoustically warm building.

For over 200 years, this space has been a centre of creativity and artistic endeavour for the community as well as an active place of Christian worship.

The church building is used as a venue for many genres of music as well as for lectures, conferences and filming.



At the front of the nave, adjacent to the pulpit, there is a large flat flexible space.

When appropriate, the red carpeted sanctuary area can be used for additional performers and the altar can be moved backwards towards the east wall, for events where space needs to be maximised.



The building can seat an audience of up to 415 people at ground floor level.

Due to the slender design of the columns that support the balcony, few seats have a restricted view.

The central aisle is wide enough to allow for a line of tables while maintaining space for people to pass down one or both sides.



The upstairs gallery level can be made available to supplement the downstairs seating. It has a maximum capacity of 200 people, albeit many seats have restricted sight-lines.

It is also suitable for a small group, such as a vocal or brass ensemble, to create a remote offstage soundscape, or as a site for cameras.

The main church organ, by Gray & Davidson is situated in the gallery at the west end of the church.

Its three manual console and pedal board is played from the gallery with a sight-line to the sanctuary at the front of the church.

The church also has a movable two manual and pedal chamber (or continuo) organ by Peter Collins and Yamaha C5 concert grand piano.



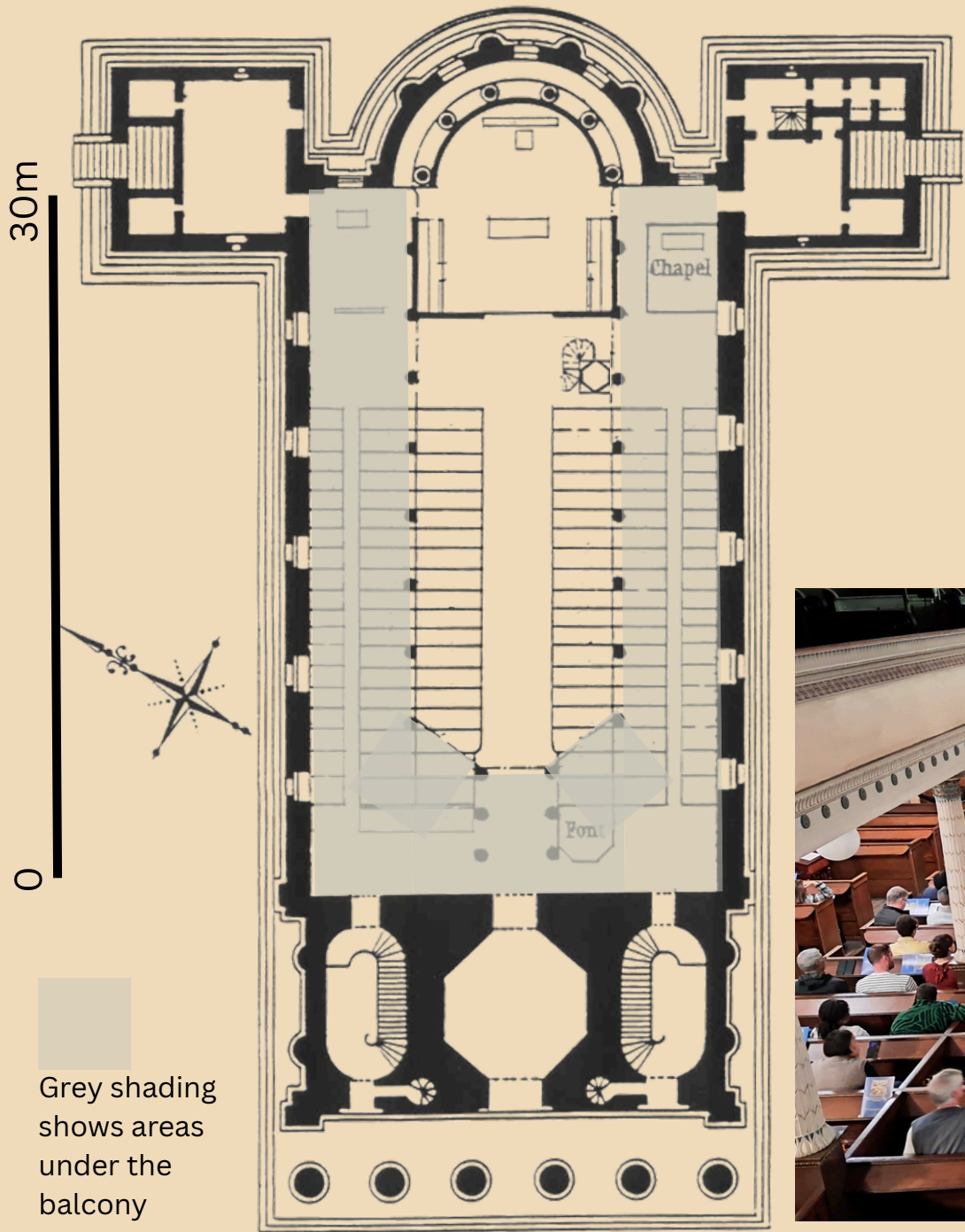

Approx. measurements Ground Floor

Side to side

- pillar to pillar: 9.1m
- pillar to pulpit: 6.75m
- each side aisle: 4.55m
- sanctuary (level 1): 5.2m
- sanctuary (level 2): 6.9m
- altar platform: 3.7m
- central aisle gap: 3.1m

Front to back

- front pew to sanctuary low wall: 4.25m
- front pew to sanctuary step: 4.15m
- sanctuary (level 1): 2.9m

Grey shading shows areas under the balcony

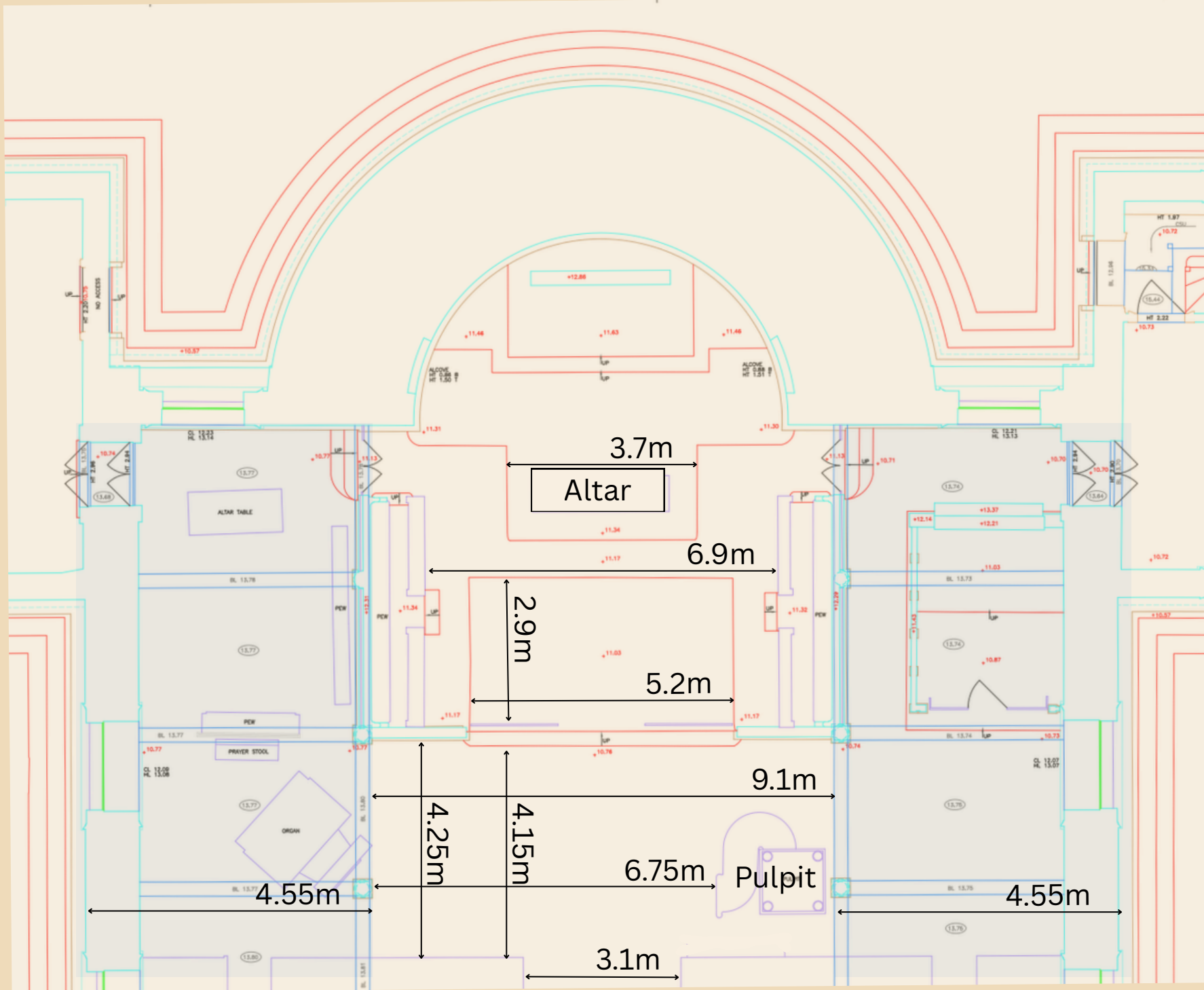
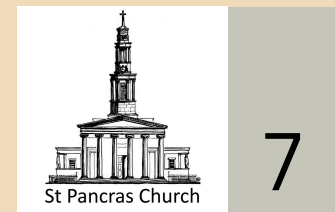

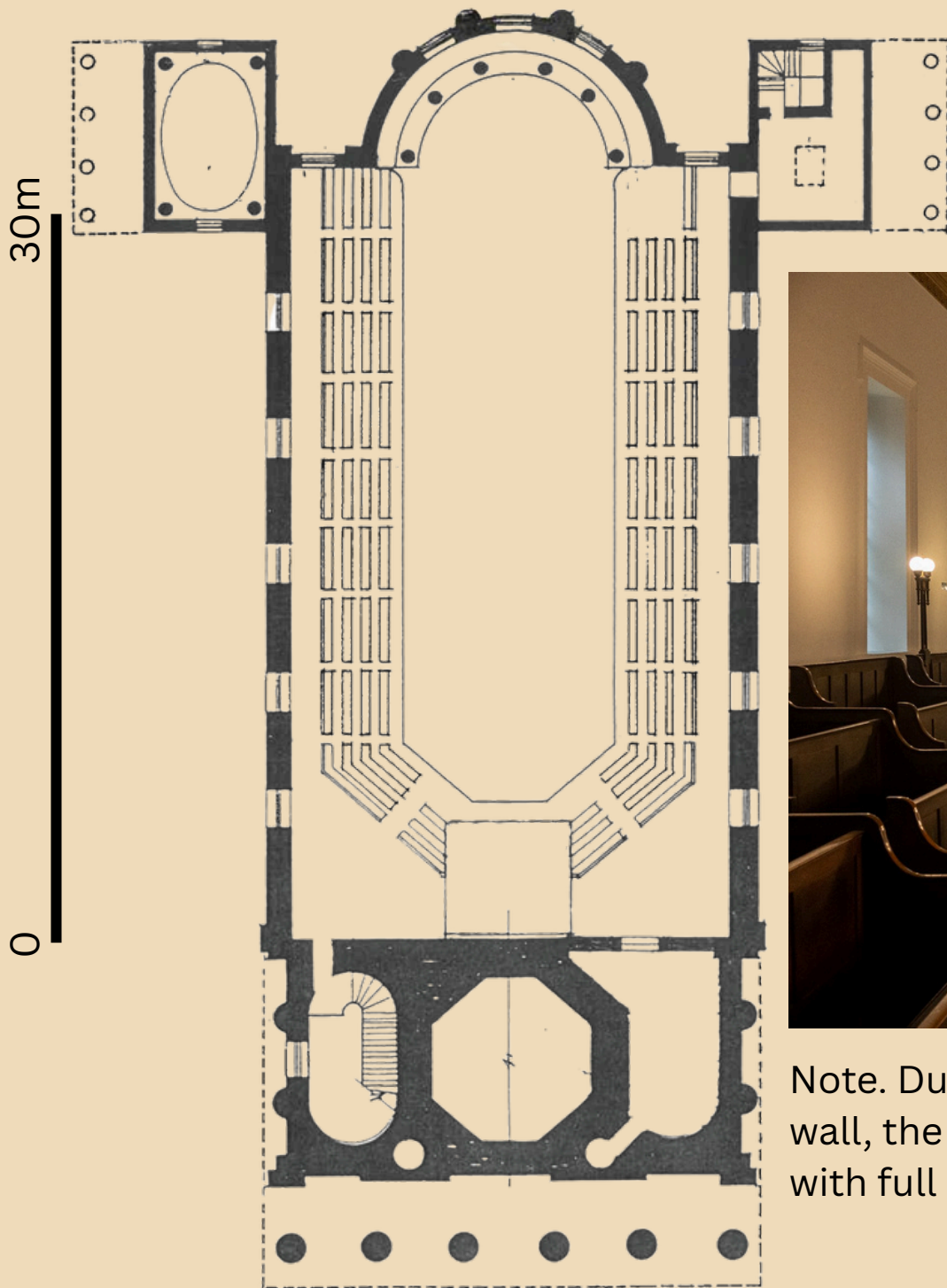

The gallery level provides the opportunity to seat up to another 200 hundred people.



Note. Due to steep stairs and low parapet wall, the gallery level is restricted to guests with full mobility who are over 18 years old.

Afternoon / Evening Hire Charges (February – November 2026)

Hire Period (in Hours)	Up to 4	4.5	5.0	5.5	6.0	6.5	7.0	7.5	8.0	8.5
Standard Charge	£980	£1,105	£1,230	£1,355	£1,480	£1,605	£1,730	£1,855	£1,980	£2,105

Minimum hire 4 hours. Audiences must be out and doors closed by 22:30. Building must be cleared and fully vacated by 23:00.

Standard hire prices include:

- The downstairs of the church
- A House Manager
- A Event Assistant
- First Security Guard
- A car parking space

Charity Discount: A fixed discount of £100 applies for registered charities

Midweek Discount: A fixed discount of £80 applies for hires between Monday and Thursday evenings (January to November)

Because we are a church, we do not charge VAT.

Extras:

- Late Ending supplement of £60 per half-hour for hires ending between 10pm and 11pm
- Extra staffing and / or security
- Use of the church's Audio Visual and streaming equipment
- Use of the gallery
- Use of the church's organs and piano
- Bar & licensing charges
- Hire of supplementary toilets
- Additional car parking spaces

Please see our schedule of Standard and Additional charges

We are happy to discuss pricing and options for extraordinary set-up or strike.

These rates do not apply for filming. Please contact us if you wish to film in the church

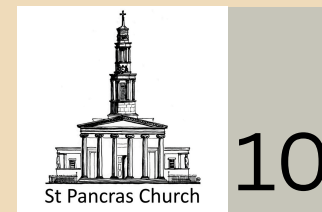

What is included within the Hire Charge?

Spaces

Our hire fees include respectful use of the main ground floor church space (nave, north and south aisles, with access via the main central doors onto Upper Woburn Place via an octagonal porch, plus use of the south vestry (often used as a green room) and the accessible toilet which is reached via the south vestry. The two side chapels at the front of the north and south aisles may be used respectfully as wings or for storage.

Additional areas, requiring express agreement, are the sanctuary (red carpeted area), the north and south vestibules at the east end of the church. The church office which is in the north vestry is not available for hirers. The gallery is available at an extra charge.

Toilets: The church has one internal accessible toilet, reached via the South Vestry. Additional toilets can be arranged and situated in the church car park.

Car park: One space in our car park is available to a hirer within the hire charge. Further spaces can be booked on-line through Just Park, if they are available. The church car park can be used on a temporary basis for loading / off-loading equipment.

Staffing

A house manager and an event assistant are included within the hire charge. They will be present to provide you with access and to oversee practicalities and to assist with your enquiries you.

One security guard is included within the hire cost. Security staff work under the direction of the House Manager. Additional security can be arranged at extra cost, and may be required for some events.

Further staffing: Depending on the nature, scale and duration of your proposed event, you may desire, or we may require, further staffing at your event. Extra charges apply for such staffing.



What Extra Charges are there? See our Schedule of Standard and Additional Charges.

Further staffing: Depending on the nature, scale and duration of your proposed event, you may desire, or we may require, further staffing at your event. Extra charges apply for such staffing. This may include: additional security, stewards and Audio Visual Staff.

Musical Instruments and Musicians: Charges apply if you are permitted to use the organ(s) or piano. It may be possible for us to arrange an organist or pianist and / or singers for your event, if this would be of assistance. Charges for musicians depend on what you require.

Additional Facilities: We have a a range of microphones, fixed and freestanding loudspeakers, projector and screen and basic streaming equipment, which can be made available to the hirer. (see Frequently Asked Questions, below)

Selling alcohol: If we agree to this, and if relevant licensing exemptions are obtained, a charge is made for us to submit a Temporary Event Notice to Camden Council and a fixed bar charge applies.

Overrunning Charges: Charges apply for any overrun (beyond your pre-booked period); **BUT please note not all overruns will be permitted:** unless exceptional arrangements have been agreed with us at the time of booking, all performances must end (whether completed or not) such that the audience has left the building and the doors are closed by 22:00; and the building must be clear of people and equipment and vacated by 23:00.

Charges also apply if the building is not left cleared, clean and tidy.



Respectful Use

The church is a sacred space and a grade 1 listed building. It is not, therefore, suited to all events, or all musical or artistic performances. We will ask you to provide accurate information about your proposed event and we reserve the right to cancel any hire contract if in our opinion it becomes likely that the content or nature of the event or the proposed use of our spaces would breach the restrictions in our terms and conditions.

Church Hiring Application Form and form of agreement

Our Church Hire Application Form and a copy the form of our Standard Hiring Charges and Terms are available on request and can be downloaded from www.stpancraschurch.org/church-hire

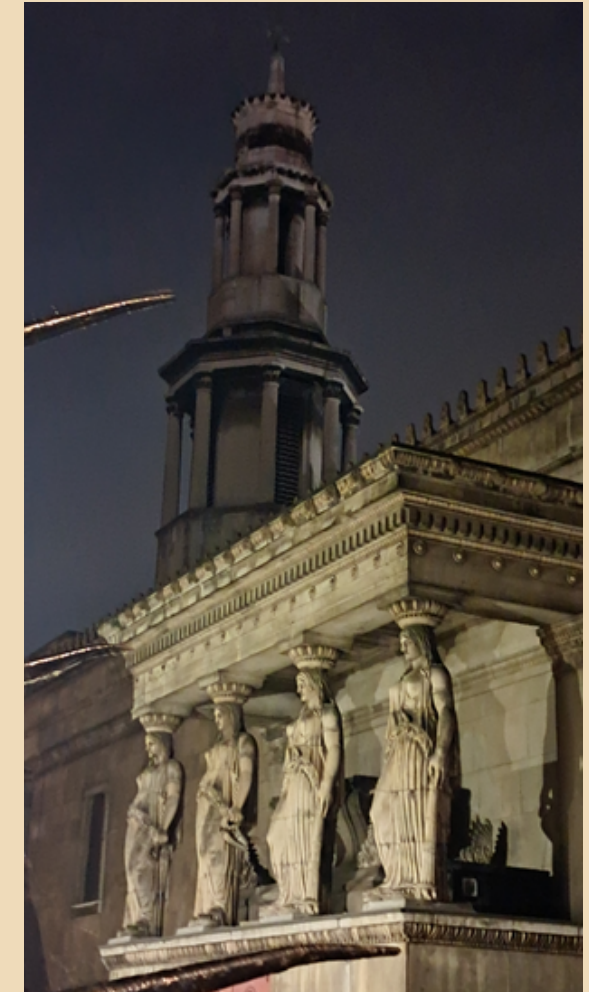

[Click Here to Download Church Hire Application Form Standard Charges and Terms](#)



Frequently Asked Questions

Tell us more about your sound system and do you have a hearing-aid loop

We have a system which is generally considered adequate for the spoken voice. This includes 2 radio lapel microphones, one hand held radio microphone and one wired lectern microphone. These are mixed and feed fixed wall mounted loudspeakers downstairs. (Note: there are no fixed loudspeakers upstairs in the gallery.) We also have two freestanding active loudspeaker systems (1 x HK AudioPolar 10 Max. SPL peak - 127 dB; and 1 x Turbosound, iNSPIRE iP500 (Max. SPL peak - 118 dB)). These can be used independently or together and a feed from the church's microphones / mixer can be used as an input to these loudspeakers. Yes, we have a hearing-aid loop system.

Do you have an internet connection, Wi-Fi, and streaming facilities?

We have a fast internet connection and we have wifi around the church building (a private network for event participants takes precedence over our open public network. We have basic ability to stream, that we use for services and recitals, but it has only one camera and limited audio facilities (see our YouTube channel). We offer use of our facilities with AV staff if appropriate; but you may prefer to hire your own videographer.

Tell us about your screen and projector

We have a projector and a large screen (3m wide by 1.7m tall) which can be raised on benches so that there are good sight-lines for most people. Hirers need to bring their own laptop with an HDMI output.

Can hirers bring or arrange staging, lighting, sound or other AV equipment?

Yes. We understand that staging can improve sight-lines for both participants and audiences and that some events require stage lighting and enhanced sound equipment. A site visit would be necessary so that you can check measurements and we can discuss your proposals and logistics (including power, delivery, set-up and packing up and removal). The hirer is responsible for all aspects of safety relating to any staging, lighting, audio or other equipment that they use and must check that its use is covered by the hirer's third party liability insurance.

Do you have any music stands that we can use?

Yes. We have 12 music stands. We also have a conductors dais (see photo, page 2).

Do you have tables and chairs that we can use?

Yes. We have 50 folding chairs; 4 large folding tables (~182cm x 76cm); 4 smaller folding tables (~120cm x 60cm) and 4 circular tables (~90cm diameter).

Other Spaces that St Pancras Church Makes Available for Hire

Crypt Gallery - info@cryptgallery.org



Church Hall - office@stpancraschurch.org



Church Gardens - office@stpancraschurch.org



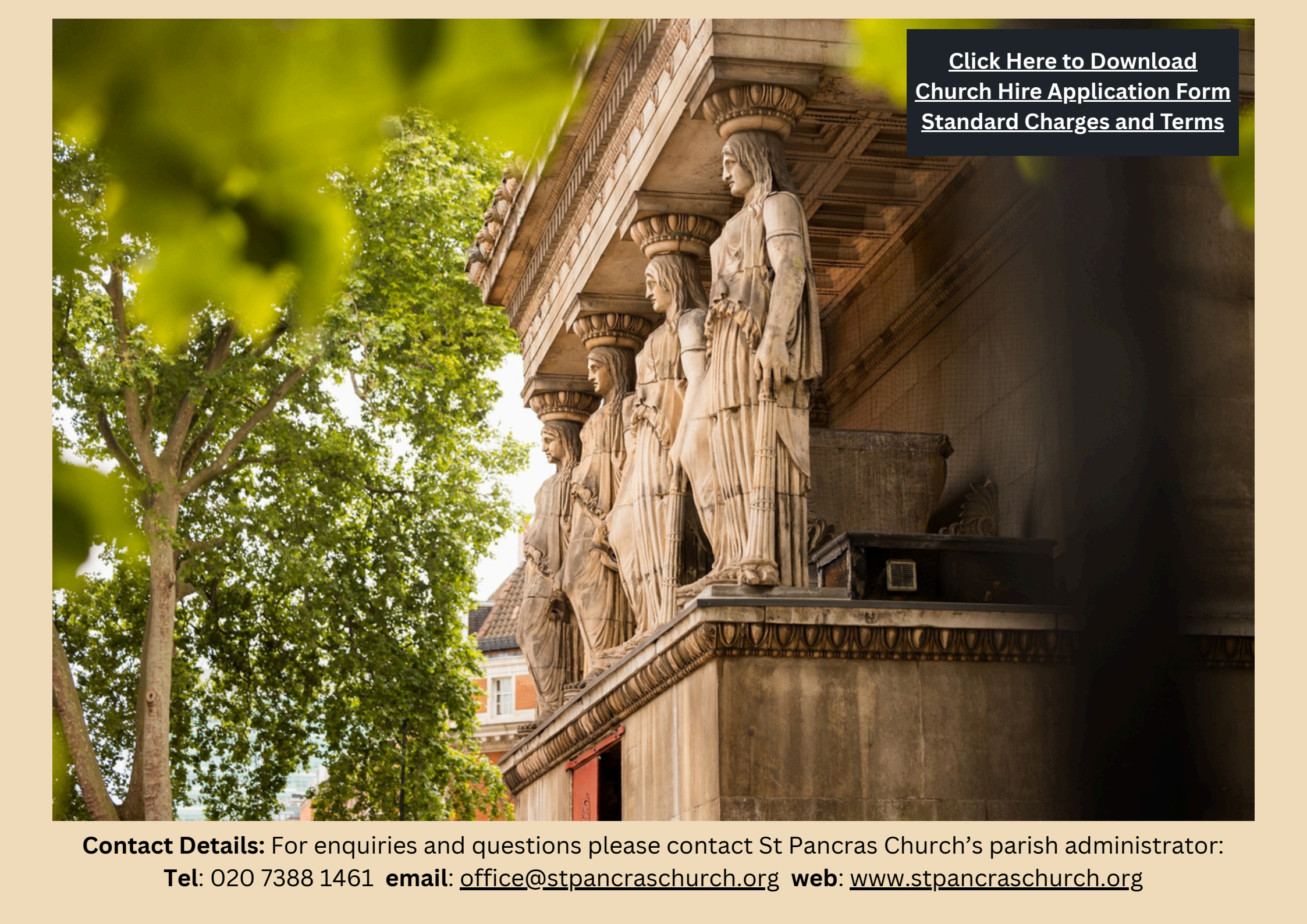

[Click Here to Download Church Hire Application Form Standard Charges and Terms](#)

Contact Details: For enquiries and questions please contact St Pancras Church's parish administrator:
Tel: 020 7388 1461 **email:** office@stpancraschurch.org **web:** www.stpancraschurch.org